

"THE RISE" STAGE 1 & 2 SEWER PLANS LEE ST & ARILPA CT - KANGAROO FLAT

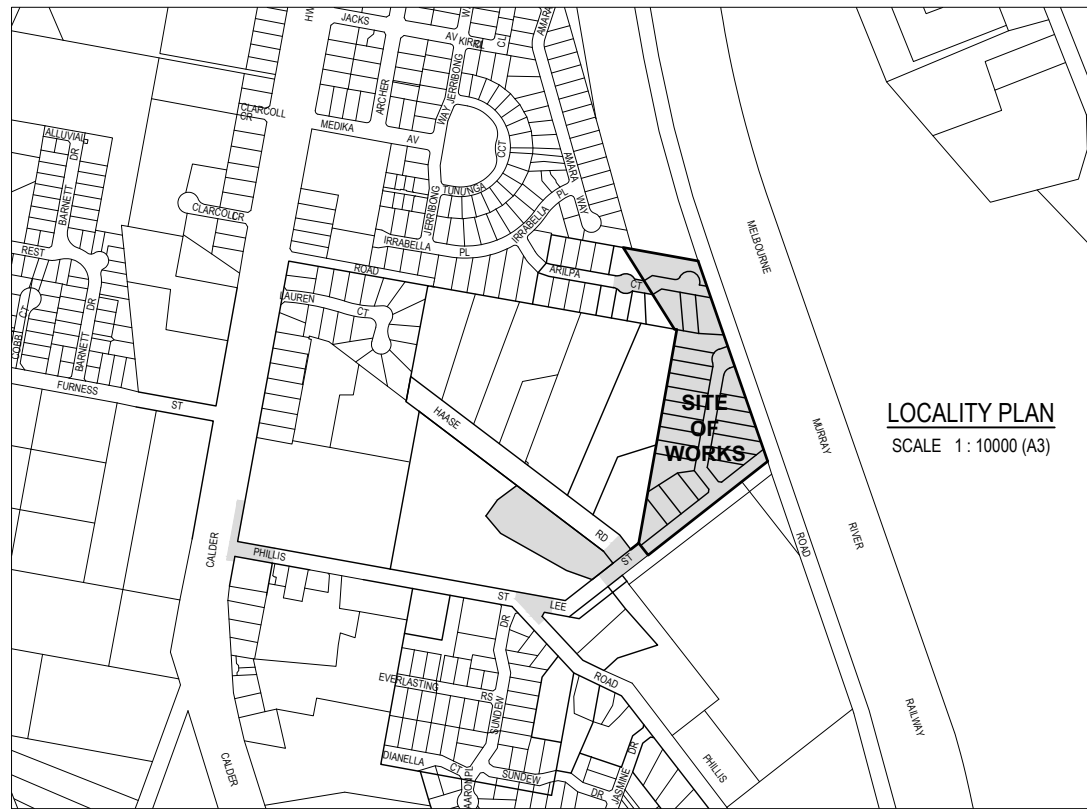

- LEGEND**
- S — PROPOSED GRAVITY SEWER
 - LPS — PROPOSED LOW PRESSURE SEWER
 - - - EX S - - - EXISTING SEWER
 - - - F S - - - FUTURE SEWER
 - (S) EXISTING MANHOLE (MH)
 - PROPOSED MANHOLE (MH)
 - (MS) EXISTING MAINTENANCE SHAFT (MS)
 - PROPOSED MAINTENANCE SHAFT (MS)
 - (TMS) EXISTING TERMINAL MAINTENANCE SHAFT (TMS)
 - PROPOSED TERMINAL MAINTENANCE SHAFT (TMS)
 - (IO) EXISTING INSPECTION OPENING (IO)
 - PROPOSED ISOLATION VALVE
 - (M) PROPOSED BOUNDARY CONNECTION KIT
 - PROPOSED FLUSHING POINT
 - PROPOSED DRAIN / PIT / I.S.
 - - - EX D - - - EXISTING DRAIN / PIT

GENERAL NOTES

GENERAL

- ALL LEVELS ARE IN METRES TO AUSTRALIAN HEIGHT DATUM (A.H.D)
- SEWER MAINS WILL BE INSTALLED IN ACCORDANCE WITH THE SEWERAGE CODE OF AUSTRALIA (WSA 02:2002-2.3, MELBOURNE RETAIL WATER AGENCIES EDITION, VERSION 1.0) AND ASSOCIATED COLIBAN WATER ADDENDUM.
- NUMBER OF LOTS SERVICED : 21 STAGE 1 & 3 STAGE 2
- LENGTH OF PIPELINE TO BE CONSTRUCTED
1500 PVC (CLASS SN8) = 566 Lm (STAGE 1)
1800 PE (CLASS SN 10) = 47 Lm (STAGE 1)
630 PE (CLASS SN 10) = 68 Lm (STAGE 2)
- NOTE TO CONTRACTOR - THE CONSULTING ENGINEER IS RESPONSIBLE FOR THE DESIGN AND MANAGEMENT OF THE CONSTRUCTION WORKS. ANY PROBLEMS ARISING DURING CONSTRUCTION SHALL BE DIRECTED TO THE CONSULTANT.
- NO TBM CAN BE USED WITHOUT FIRST PROVING IT TO BE CORRECT TO A SECOND TBM. TOMKINSON IS TO BE NOTIFIED OF ANY DISCREPANCIES IMMEDIATELY. NO HORIZONTAL SETOUT CONTROL CAN BE USED WITHOUT FIRST PROVING IT TO BE CORRECT TO A THIRD KNOWN POINT. TOMKINSON GROUP IS TO BE NOTIFIED OF ANY DISCREPANCIES IMMEDIATELY. TITLE PEGS AND T.B.M.'S TO BE RE-ESTABLISHED BY A LICENSED SURVEYOR IF FOUND TO BE MISSING.

PIPELINE CONSTRUCTION

- PIPELINE CONSTRUCTION IS TO BE WITH THE FOLLOWING MATERIALS UNLESS OTHERWISE DETAILED ON THE DRAWINGS
PIPE TYPE: PVC
PIPE CLASS: SN8 (1500 & GREATER) - SN6 (1000)
AUSTRALIAN STANDARD: AS 1260
PIPE TYPE: PE GRAVITY
PIPE CLASS: SN 10 (1800)
PIPE TYPE: PE PRESSURE PIPELINE
PIPE CLASS: PN 12.5 (630)
- LOW PRESSURE SEWER RISING MAIN TO BE LAID WITH MIN 0.9m FINISHED COVER AND TRENCH IS TO BE BACKFILLED WITH CRUSHED ROCK. POSITIVE GRADE FROM FLUSHING POINT TO MANHOLE CONNECTION TO BE ACHIEVED TO AVOID TRAPPED LOW POINTS.

PIPE JOINTING

- PRECAST RUBBER RING OR MASTIC JOINTED ACCESS CHAMBER SYSTEMS ARE TO BE USED. PVC MANHOLES NOT TO BE USED.

PROPERTY BRANCH SEWERS

- ALL PROPERTIES ARE BOUNDARY TRAP OMITTED

ACCESS CHAMBERS

- ALL CHAMBERS SHALL BE 1000mm DIA UNLESS SHOWN OTHERWISE

CHAMBER COVERS

- ALL ACCESS CHAMBER COVERS SHALL BE CIRCULAR DUCTILE IRON SOLID DN600 COVERS THAT COMPLY WITH AS3996 AND WSA 104 UNLESS OTHERWISE SPECIFIED, WITH NOMINAL 600mm OPENING - CLASS 'D' IN ROAD RESERVES AND ALONG PROPERTY FRONTAGES
- ALL CHAMBER COVERS SHALL BE LEVEL WITH AND SHALL CONFORM TO SLOPE AND CROSSFALL OF THE FINISHED SURFACE. THE FINISHED SURFACE LEVELS ARE TO BE CONFIRMED WITH THE SUPERINTENDENT AND ROAD CONTRACTOR PRIOR TO CONSTRUCTION.

OUTLET

- THESE BRANCHES DRAIN DIRECTLY TO EXISTING SEWERS.

EARTHWORKS

- IN AREAS SUBJECT TO EARTHWORKS, THE CONSTRUCTION OF SEWERS MUST NOT COMMENCE UNTIL THE EARTHWORKS HAVE BEEN COMPLETED OR THE SUPERINTENDENT GIVES WRITTEN NOTICE TO COMMENCE.

SERVICE CONNECTIONS

- ALL NEW SERVICE CONNECTIONS MUST BE IN ACCORDANCE WITH THE REQUIREMENTS OF COLIBAN WATER SPECIFICATIONS

REINSTATEMENT OF DISTURBED AREAS

- ON COMPLETION OF SEWER WORKS, THE CONTRACTOR MUST REINSTATE TO THE SATISFACTION OF THE SUPERINTENDENT AND TO THE RESPONSIBLE AUTHORITY ANY AREAS, STRUCTURES, PAVEMENTS OR SERVICES DAMAGED, DIRTIED OR MADE UNSERVICEABLE DUE TO CONSTRUCTION WORKS.

CONNECTION TO LIVE SEWER

- NO CONNECTION TO EXISTING AUTHORITY SERVICES WILL BE PERMITTED WITHOUT ATTENDANCE BY THE AUTHORITY PERSONNEL AND WITH COLIBAN WATER PERSONNEL BEING PROVIDED WITH A MINIMUM OF FIVE (5) DAYS PRIOR WRITTEN NOTIFICATION DUE TO CONSTRUCTION WORKS.

SERVICES

- THE CONTRACTOR MUST CONTACT DIAL BEFORE YOU DIG (CALL 1100), OR VISIT THE DIAL BEFORE YOU DIG WEBSITE PRIOR TO COMMENCING WORKS AND SATISFY THEMSELVES THAT THERE ARE NO SERVICES WITHIN THE VICINITY OF THE WORK AREA
- NO WORK IS TO COMMENCE BEFORE THE CONTRACTOR HAS ASCERTAINED WHAT UNDERGROUND SERVICES ARE PRESENT
- CONTRACTOR MUST FOLLOW THE "NO GO ZONE" SAFETY PROCEDURES AT ALL TIMES, WHICH ARE AVAILABLE FROM ALL UTILITY AND TELECOMMUNICATIONS COMPANIES, INCLUDING THE OFFICE OF THE CHIEF ELECTRICAL INSPECTOR, THE OFFICE OF GAS SAFETY AND WORKSAFE VICTORIA
- IF THESE SAFETY PROCEDURES CANNOT BE COMPLIED WITH THEN NO WORK IS TO BE UNDERTAKEN WITHOUT PERMISSION FROM THE UTILITY COMPANY
- THE PROJECT AREA CONTAINS THE FOLLOWING SERVICES FOR ASSISTANCE IN EMERGENCY CONTACT.

SERVICES	AUTHORITY & CONTACT	TELEPHONE
DRAINAGE	CITY OF GREATER BENDIGO	5434 6000
ELECTRICITY	POWERCOR	132 412
GAS	SP AUSNET	136 707
COMMUNICATIONS	TELSTRA	132 203
SEWER & WATER	COLIBAN WATER	1300 363 200

TABLE OF OFFSETS FOR SERVICES

STREET	GAS		WATER		ELECTRICITY				TELSTRA	
	OFFSET	SIDE	OFFSET	SIDE	POLE OFFSET	SIDE	U/G CABLE OFFSET	SIDE	OFFSET	SIDE
LEE STREET (EXTENSION)	1.9m	NORTH	2.3m	NORTH	-	-	1.4m	SOUTH	0.9m	SOUTH
ROAD 1	1.9m	WEST	2.3m	WEST	-	-	2.4m	EAST	1.9m	EAST
ARILPA COURT (EXTENSION)	2.9m	SOUTH	3.3m	SOUTH	-	-	2.4m	SOUTH	1.9m	SOUTH
RAILWAY STREET	-	-	-	-	-	-	6.0m	WEST	-	-

DRAWING LIST

SEWER CONSTRUCTION PLANS

- 1070601S01 LOCALITY PLAN & GENERAL NOTES
- 1070601S02 SEWER DETAIL PLAN
- 1070601S03-S07 SEWER LONG SECTIONS (5 SHEETS)

CONCEPT PLAN

© COPYRIGHT. THE INFORMATION CONTAINED ON THIS DRAWING IS THE INTELLECTUAL PROPERTY OF TOMKINSON GROUP. COPYING OR USING THIS DRAWING IN WHOLE OR IN PART WITHOUT THE EXPRESS WRITTEN PERMISSION OF TOMKINSON GROUP INFRINGES COPYRIGHT

REV	REVISION	DES	DWG	CHK	DATE
B	AS SUBMITTED TO COLIBAN WATER - FULL SITE	NJB	NJB	RK	14/12/15
A	AS SUBMITTED TO COLIBAN WATER - STAGE 1 OUTFALL ONLY	NJB	NJB	-	07/10/15

tomkinson Group
PROJECT MANAGERS DEVELOPMENT PLANNERS
LICENSED SURVEYORS CIVIL ENGINEERS
FREECALL: 1800 810 170 TEL: (03) 5445 8700 FAX: (03) 5441 3648
PO BOX 421, BENDIGO 3552 57 MYERS STREET, BENDIGO 3550
WEB: www.tomkinson.com EMAIL: bendigo@tomkinson.com

Principal CREJS PTY LTD

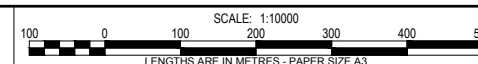

Water Authority & Ref:
COLIBAN WATER
ME - TBA

"THE RISE" STAGES 1 & 2
LEE STRET & ARILPA COURT - KANGAROO FLAT
SHEET DESCRIPTION

SHT 1 of 7 REV B

Drawing No.
1070601S01

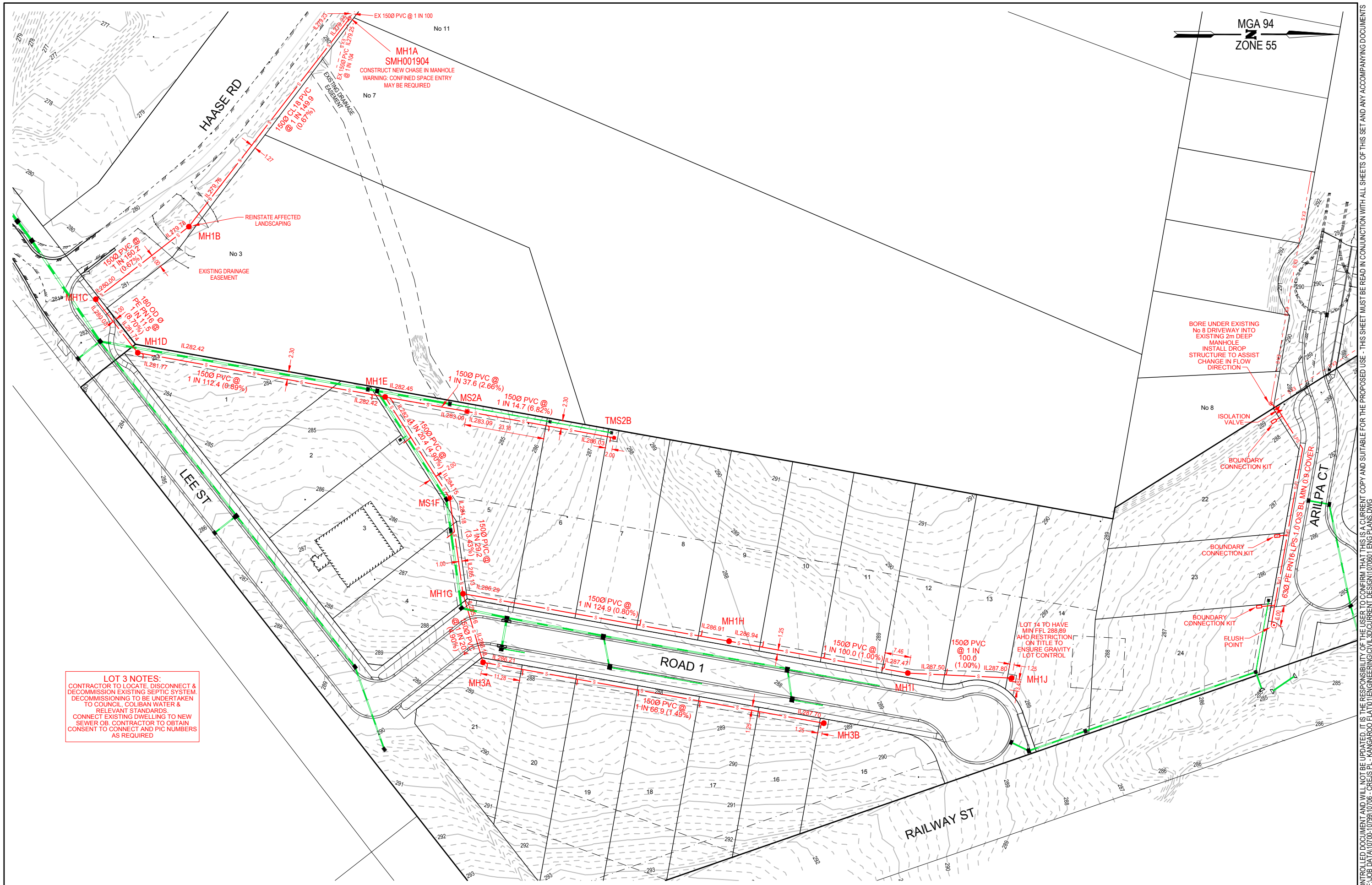

LOT 3 NOTES:
 CONTRACTOR TO LOCATE, DISCONNECT & DECOMMISSION EXISTING SEPTIC SYSTEM. DECOMMISSIONING TO BE UNDERTAKEN TO COUNCIL, COLIBAN WATER & RELEVANT STANDARDS.
 CONNECT EXISTING DWELLING TO NEW SEWER OR CONTRACTOR TO OBTAIN CONSENT TO CONNECT AND PIC NUMBERS AS REQUIRED

CONCEPT PLAN

© COPYRIGHT. THE INFORMATION CONTAINED ON THIS DRAWING IS THE INTELLECTUAL PROPERTY OF TOMKINSON GROUP. COPYING OR USING THIS DRAWING IN WHOLE OR IN PART WITHOUT THE EXPRESS WRITTEN PERMISSION OF TOMKINSON GROUP INFRINGES COPYRIGHT

REV	DES	DWG	CHK	DATE	REVISION
B	AS	AS	AS	14/12/15	AS SUBMITTED TO COLIBAN WATER - FULL SITE
A	AS	AS	AS	07/10/15	AS SUBMITTED TO COLIBAN WATER - STAGE 1 OUTFALL ONLY

Tomkinson Group
 PROJECT MANAGERS DEVELOPMENT PLANNERS
 LICENSED SURVEYORS CIVIL ENGINEERS
 FREECALL: 1800 810 170 TEL: (03) 5445 8700 FAX: (03) 5441 3648
 PO BOX 421, BENDIGO 3552 57 MYERS STREET, BENDIGO 3550
 WEB: www.tomkinson.com EMAIL: bendigo@tomkinson.com

Principal CREJS PTY LTD

SCALE: 1:1000
 LENGTHS ARE IN METRES - PAPER SIZE A3

"THE RISE" STAGES 1 & 2
 LEE STRET & ARILPA COURT - KANGAROO FLAT
 SHEET DESCRIPTION

Water Authority & Ref:
 COLIBAN WATER
 ME - TBA

SHT 2 of 7 REV B

Drawing No.
 1070601S02

NOTE: THIS PLAN IS AN UNCONTROLLED DOCUMENT AND WILL NOT BE UPDATED. IT IS THE RESPONSIBILITY OF THE USER TO CONFIRM THAT THIS IS A CURRENT COPY AND SUITABLE FOR THE PROPOSED USE. THIS SHEET MUST BE READ IN CONJUNCTION WITH ALL SHEETS OF THIS SET AND ANY ACCOMPANYING DOCUMENTS
 FILE: 14/12/2015 - P:\JOB DATA\10706010706 - CREJS PL - KANGAROO FLAT\1070601\1070601.DWG

NOTE:

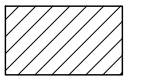

DENOTES 3% CEMENT
STABILISED FULL DEPTH
FOR BACKFILL
REFER STANDARD NOTES

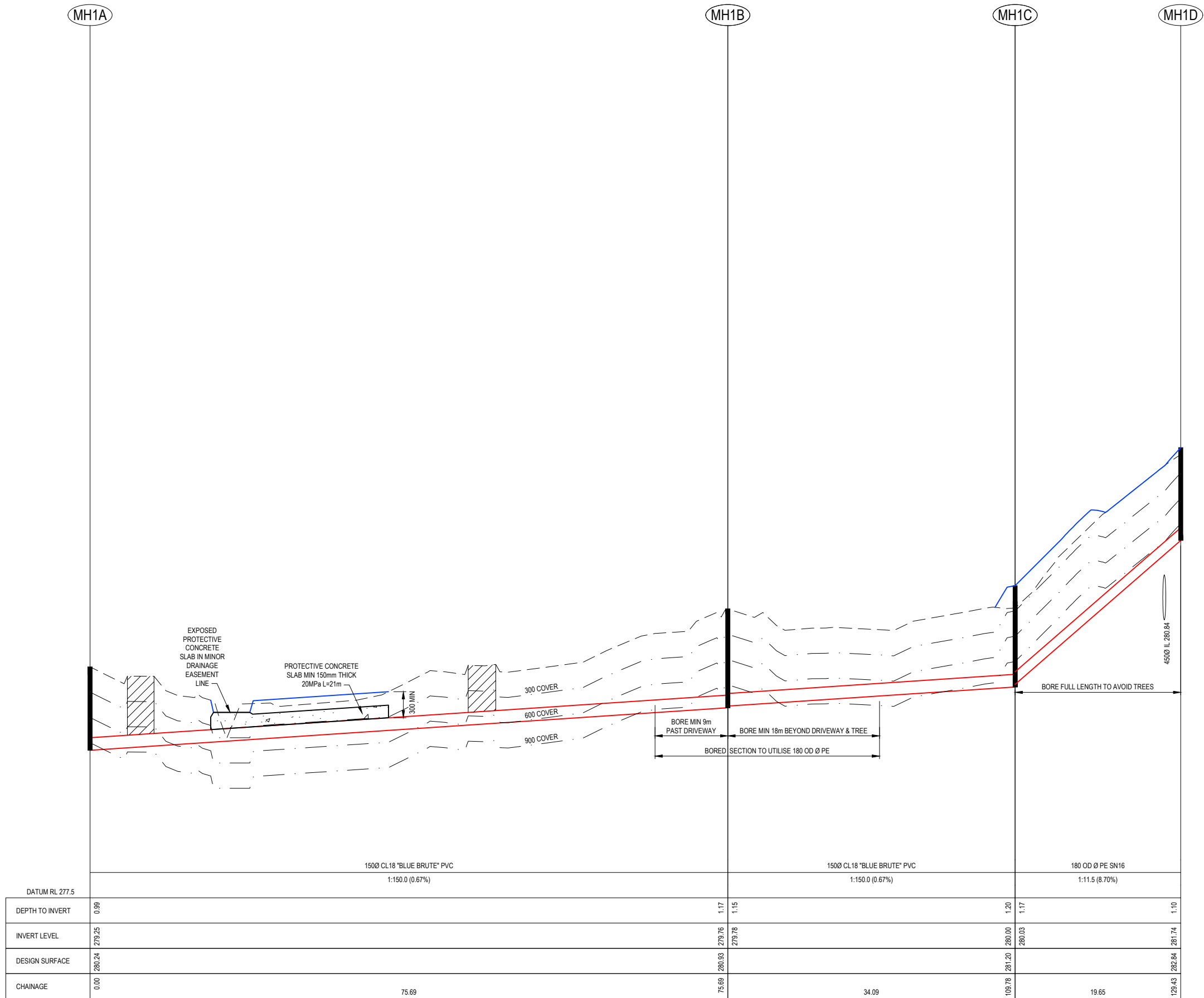

		1500 CL18 "BLUE BRUTE" PVC 1:150.0 (0.67%)		1500 CL18 "BLUE BRUTE" PVC 1:150.0 (0.67%)		180 OD Ø PE SN16 1:11.5 (8.70%)
DATUM RL 277.5						
DEPTH TO INVERT	0.99		1.17	1.15	1.20	1.10
INVERT LEVEL	279.25		279.76	279.78	280.00	281.74
DESIGN SURFACE	280.24		280.03		280.03	282.84
CHAINAGE	0.00	75.69	75.69	34.09	109.78	129.43

CONCEPT PLAN

© COPYRIGHT. THE INFORMATION CONTAINED ON THIS DRAWING IS THE INTELLECTUAL PROPERTY OF TOMKINSON GROUP. COPYING OR USING THIS DRAWING IN WHOLE OR IN PART WITHOUT THE EXPRESS WRITTEN PERMISSION OF TOMKINSON GROUP INFRINGES COPYRIGHT

REV	REVISION	DES	DWG	CHK	DATE
B	AS SUBMITTED TO COLIBAN WATER - FULL SITE	NJB	NJB	RK	14/12/15
A	AS SUBMITTED TO COLIBAN WATER - STAGE 1 OUTFALL ONLY	NJB	NJB		07/10/15

tomkinson Group
 PROJECT MANAGERS DEVELOPMENT PLANNERS
 LICENSED SURVEYORS CIVIL ENGINEERS
 FREECALL: 1800 810 170 TEL: (03) 5445 8700 FAX: (03) 5441 3648
 PO BOX 421, BENDIGO 3552 57 MYERS STREET, BENDIGO 3550
 WEB: www.tomkinson.com EMAIL: bendigo@tomkinson.com

Principal CREJS PTY LTD
 "THE RISE" STAGES 1 & 2
 LEE STRET & ARILPA COURT - KANGAROO FLAT
 SEWER LONG SECTIONS (SHEET 1 OF 5)



Water Authority & Ref:
 COLIBAN
 WATER
 ME - TBA
 SHT 3 of 7 REV B
 Drawing No.
 1070601S03

NOTE: THIS PLAN IS AN UNCONTROLLED DOCUMENT AND WILL NOT BE UPDATED. IT IS THE RESPONSIBILITY OF THE USER TO CONFIRM THAT THIS IS A CURRENT COPY AND SUITABLE FOR THE PROPOSED USE. THIS SHEET MUST BE READ IN CONJUNCTION WITH ALL SHEETS OF THIS SET AND ANY ACCOMPANYING DOCUMENTS. PLOD DATE: 14/12/2015 FILE: P:\JOB DATA\1070601\06-1079510706 - CREJS PL - KANGAROO FLAT\10 ENGINEERING\CIVIL\CURRENT DESIGN\1070601 ENG PLANS.DWG

NOTE:

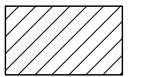

DENOTES 3% CEMENT
STABILISED FULL DEPTH
FOR BACKFILL
REFER STANDARD NOTES

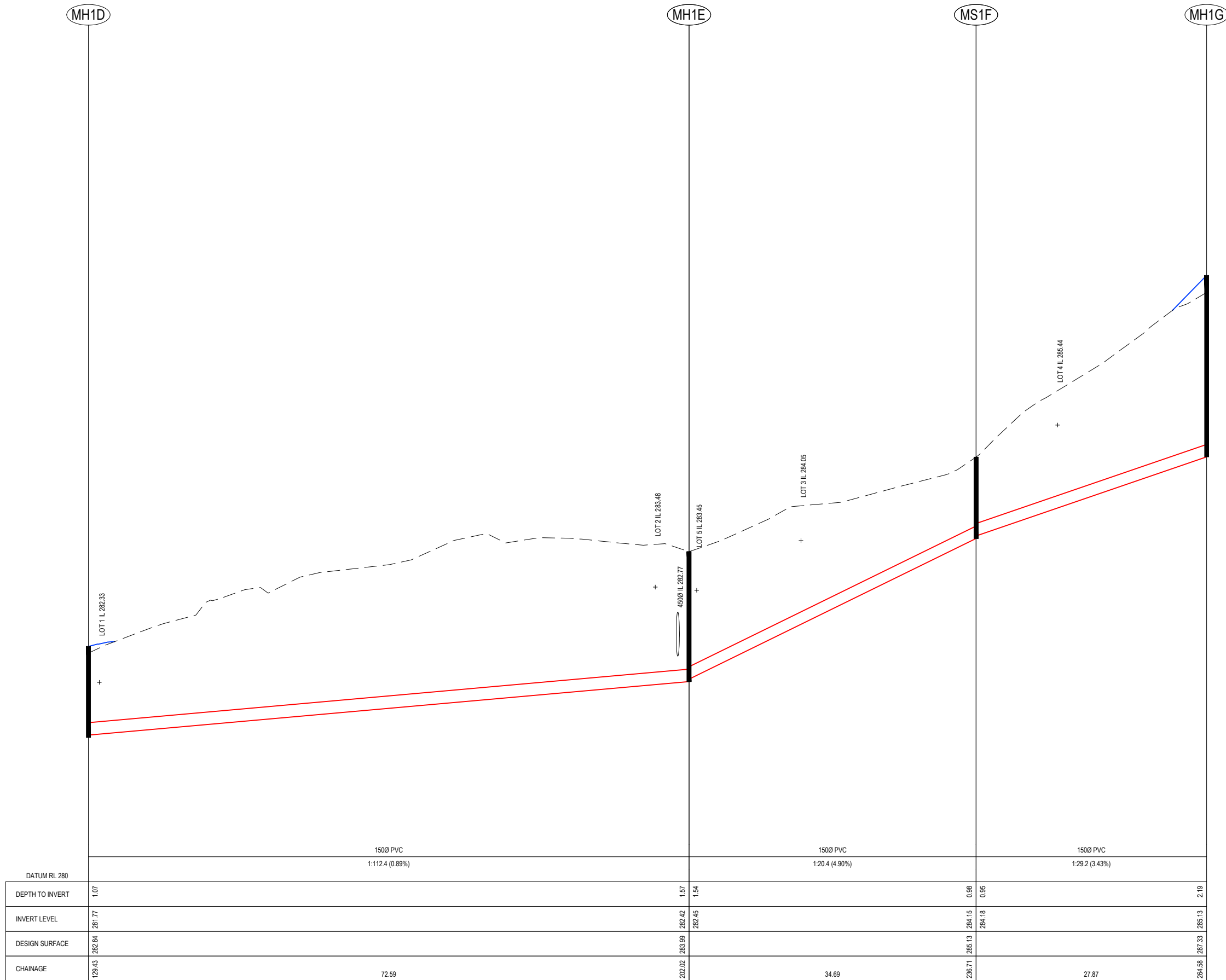

DATUM RL 280		1500 PVC	1500 PVC	1500 PVC
		1:112.4 (0.89%)	1:20.4 (4.90%)	1:29.2 (3.43%)
DEPTH TO INVERT	1.07	1.57	0.98	2.19
INVERT LEVEL	281.77	282.42	284.15	285.13
DESIGN SURFACE	282.84	283.99	285.13	287.33
CHAINAGE	129.43	202.02	34.69	264.58
		72.99		27.87

CONCEPT PLAN

© COPYRIGHT. THE INFORMATION CONTAINED ON THIS DRAWING IS THE INTELLECTUAL PROPERTY OF TOMKINSON GROUP. COPYING OR USING THIS DRAWING IN WHOLE OR IN PART WITHOUT THE EXPRESS WRITTEN PERMISSION OF TOMKINSON GROUP INFRINGES COPYRIGHT

REV	REVISION	DES	DWG	CHK	DATE
B	AS SUBMITTED TO COLIBAN WATER - FULL SITE	NJB	NJB	RK	14/12/15
A	AS SUBMITTED TO COLIBAN WATER - STAGE 1 OUTFALL ONLY	NJB	NJB		07/10/15

tomkinson Group
 PROJECT MANAGERS DEVELOPMENT PLANNERS ISO 9001:2008
 LICENSED SURVEYORS CIVIL ENGINEERS FS520488
 FREECALL: 1800 810 170 TEL: (03) 5445 8700 FAX: (03) 5441 3648
 PO BOX 421, BENDIGO 3552 57 MYERS STREET, BENDIGO 3550
 WEB: www.tomkinson.com EMAIL: bendigo@tomkinson.com

Principal CREJS PTY LTD
 "THE RISE" STAGES 1 & 2
 LEE STRET & ARILPA COURT - KANGAROO FLAT
 SEWER LONG SECTIONS (SHEET 2 OF 5)



Water Authority & Ref:
 COLIBAN
 WATER
 ME - TBA
 SHT 4 of 7 REV B
 Drawing No.
 1070601S04

NOTE: THIS PLAN IS AN UNCONTROLLED DOCUMENT AND WILL NOT BE UPDATED. IT IS THE RESPONSIBILITY OF THE USER TO CONFIRM THAT THIS IS A CURRENT COPY AND SUITABLE FOR THE PROPOSED USE - THIS SHEET MUST BE READ IN CONJUNCTION WITH ALL SHEETS OF THIS SET AND ANY ACCOMPANYING DOCUMENTS. PLOT DATE: 14/12/2015 FILE: P:\JOB DATA\1070601\06-1079510706 - CREJS PL - KANGAROO FLAT\10 ENGINEERING\CIVIL\CURRENT DESIGN\1070601 ENG PLANS.DWG

MH1G

MH1H

MH1I

MH1J

NOTE:

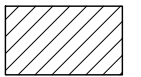

DENOTES 3% CEMENT STABILISED FULL DEPTH FCR BACKFILL REFER STANDARD NOTES

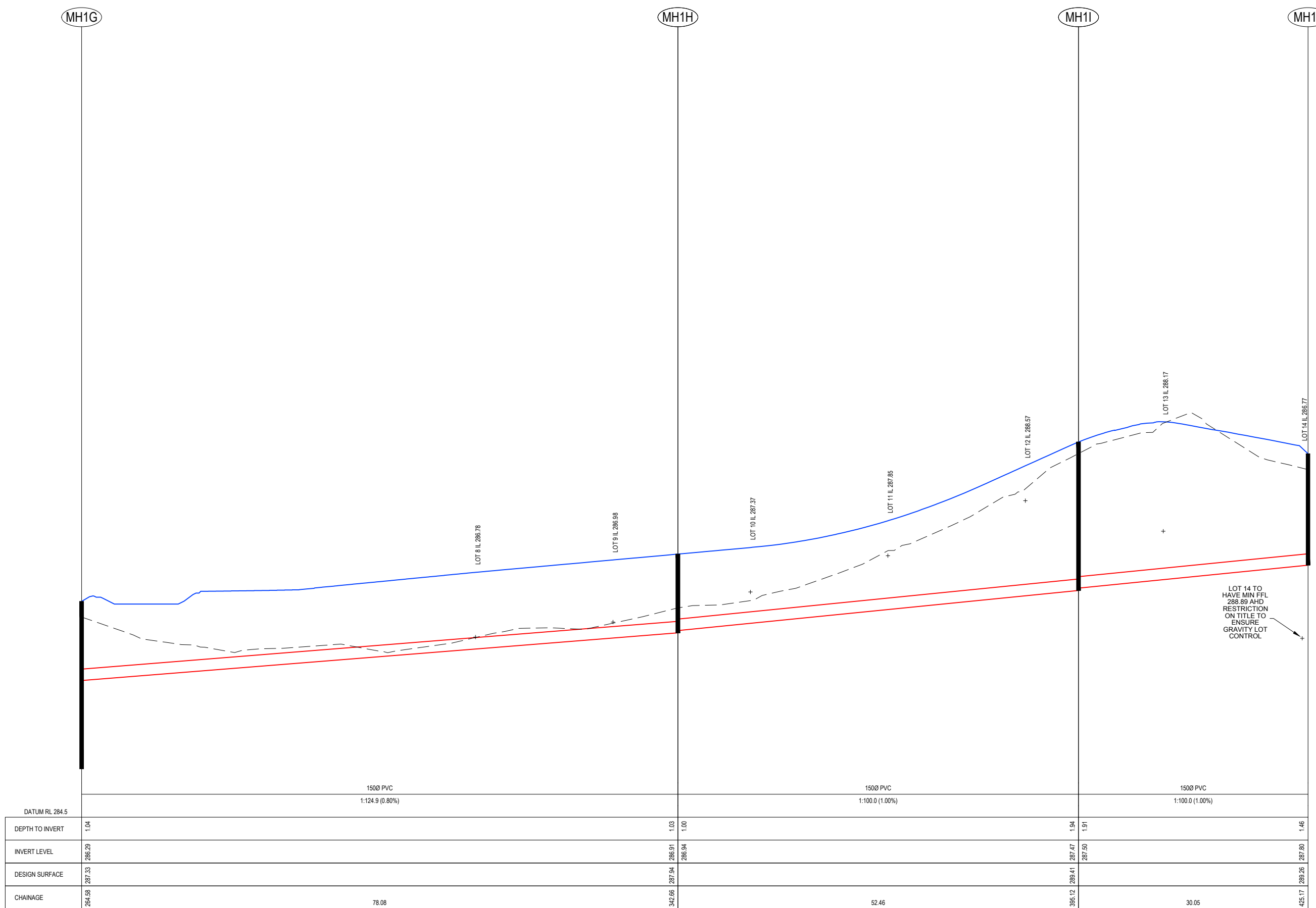

CONCEPT PLAN

© COPYRIGHT. THE INFORMATION CONTAINED ON THIS DRAWING IS THE INTELLECTUAL PROPERTY OF TOMKINSON GROUP. COPYING OR USING THIS DRAWING IN WHOLE OR IN PART WITHOUT THE EXPRESS WRITTEN PERMISSION OF TOMKINSON GROUP INFRINGES COPYRIGHT

REV	REVISION	DES	DWG	CHK	DATE
B	AS SUBMITTED TO COLIBAN WATER - FULL SITE	NJB	NJB	RK	14/12/15
A	AS SUBMITTED TO COLIBAN WATER - STAGE 1 OUTFALL ONLY	NJB	NJB		07/10/15

Tomkinson Group
 PROJECT MANAGERS DEVELOPMENT PLANNERS ISO 9001:2008
 LICENSED SURVEYORS CIVIL ENGINEERS FS520488
 FREECALL: 1800 810 170 TEL: (03) 5445 8700 FAX: (03) 5441 3648
 PO BOX 421, BENDIGO 3552 57 MYERS STREET, BENDIGO 3550
 WEB: www.tomkinson.com EMAIL: bendigo@tomkinson.com

Principal CREJS PTY LTD

"THE RISE" STAGES 1 & 2
 LEE STRET & ARILPA COURT - KANGAROO FLAT
 SEWER LONG SECTIONS (SHEET 3 OF 5)

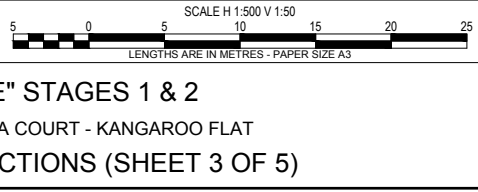

Water Authority & Ref:
 COLIBAN
 WATER
 ME - TBA

SHT 5 of 7 REV B

Drawing No.
 1070601S05

NOTE: THIS PLAN IS AN UNCONTROLLED DOCUMENT AND WILL NOT BE UPDATED. IT IS THE RESPONSIBILITY OF THE USER TO CONFIRM THAT THIS IS A CURRENT COPY AND SUITABLE FOR THE PROPOSED USE - THIS SHEET MUST BE READ IN CONJUNCTION WITH ALL SHEETS OF THIS SET AND ANY ACCOMPANYING DOCUMENTS. PLO DATE: 14/12/2015 FILE: P:\JOB DATA\1070601\06-10799\1070601-06-10799\CIVIL\CURRENT DESIGN\1070601-ENG-PLANS.DWG

NOTE:

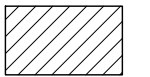

DENOTES 3% CEMENT
STABILISED FULL DEPTH
FOR BACKFILL
REFER STANDARD NOTES

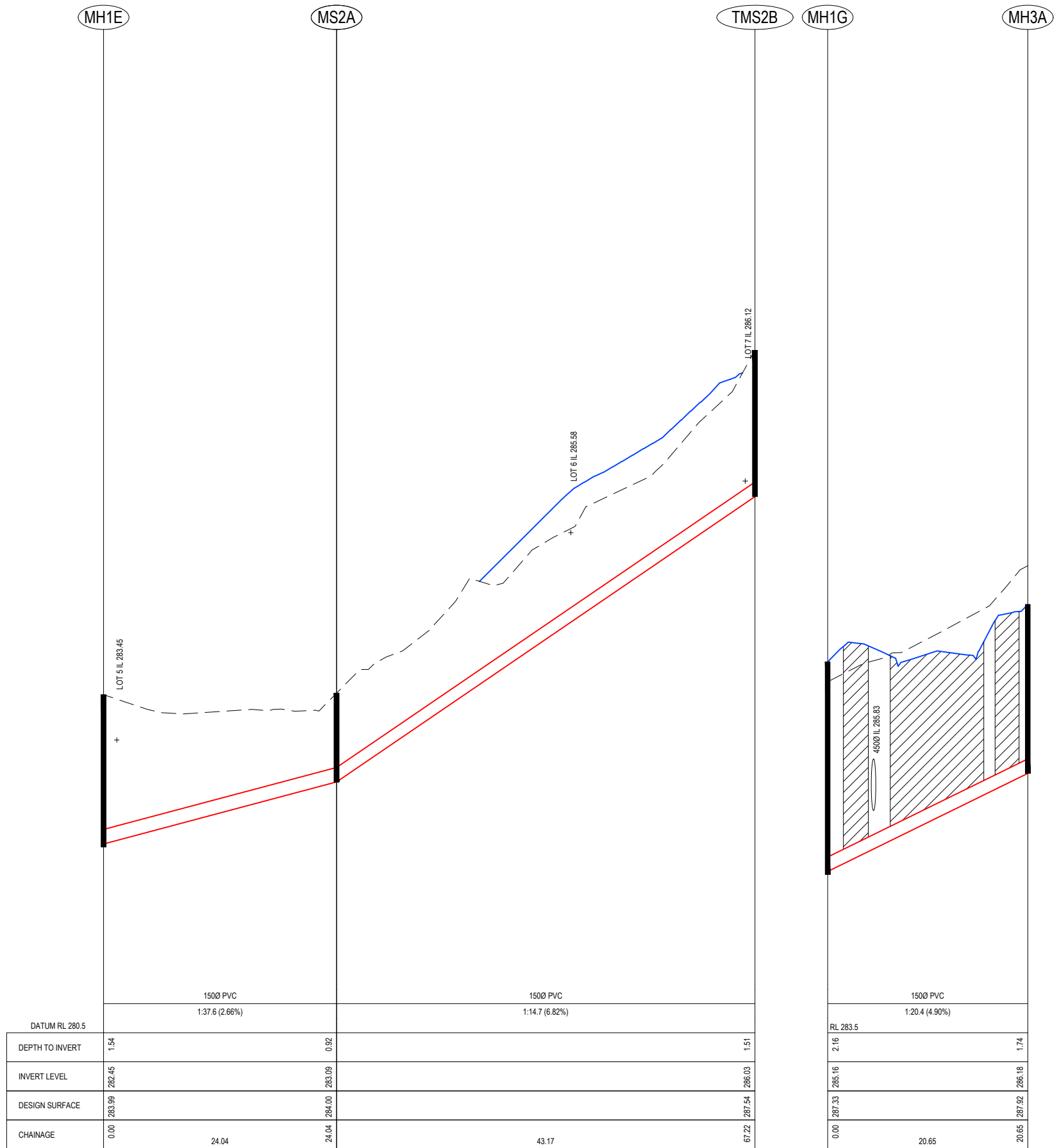

	MH1E	MS2A	TMS2B	MH1G	MH3A
DATUM RL 280.5					
DEPTH TO INVERT	1.54	0.92		1.51	
INVERT LEVEL	282.45	283.09		286.03	
DESIGN SURFACE	283.99	284.00		287.54	
CHAINAGE	0.00	24.04	43.17	67.22	
	1500 PVC 1:37.6 (2.66%)		1500 PVC 1:14.7 (6.82%)		
			1500 PVC 1:20.4 (4.90%)		
				2.16	1.74
				285.16	286.18
				0.00	20.65
				287.33	287.92

**CONCEPT
PLAN**

© COPYRIGHT. THE INFORMATION CONTAINED ON THIS DRAWING IS THE INTELLECTUAL PROPERTY OF TOMKINSON GROUP. COPYING OR USING THIS DRAWING IN WHOLE OR IN PART WITHOUT THE EXPRESS WRITTEN PERMISSION OF TOMKINSON GROUP INFRINGES COPYRIGHT

REV	REVISION	DES	DWG	CHK	DATE
B	AS SUBMITTED TO COLIBAN WATER - FULL SITE	NJB	NJB	RK	14/12/15
A	AS SUBMITTED TO COLIBAN WATER - STAGE 1 OUTFALL ONLY	NJB	NJB		07/10/15

Tomkinson Group
 PROJECT MANAGERS DEVELOPMENT PLANNERS ISO 9001:2008
 LICENSED SURVEYORS CIVIL ENGINEERS FS520488
 FREECALL: 1800 810 170 TEL: (03) 5445 8700 FAX: (03) 5441 3648
 PO BOX 421, BENDIGO 3552 57 MYERS STREET, BENDIGO 3550
 WEB: www.tomkinson.com EMAIL: bendigo@tomkinson.com

Principal CREJS PTY LTD



"THE RISE" STAGES 1 & 2
 LEE STRET & ARILPA COURT - KANGAROO FLAT
 SEWER LONG SECTIONS (SHEET 4 OF 5)

Water Authority & Ref:
 COLIBAN
 WATER
 ME - TBA

SHT 6 of 7 REV B

Drawing No.
 1070601S06

NOTE: THIS PLAN IS AN UNCONTROLLED DOCUMENT AND WILL NOT BE UPDATED. IT IS THE RESPONSIBILITY OF THE USER TO CONFIRM THAT THIS IS A CURRENT COPY AND SUITABLE FOR THE PROPOSED USE. THIS SHEET MUST BE READ IN CONJUNCTION WITH ALL SHEETS OF THIS SET AND ANY ACCOMPANYING DOCUMENTS. PLOT DATE: 14/12/2015 FILE: P:\JOB DATA\1070601\06-1070601\070601-06-1070601\CIVIL\CURRENT DESIGN\1070601-ENG-PLANS.DWG

NOTE:

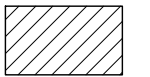

DENOTES 3% CEMENT
STABILISED FULL DEPTH
FOR BACKFILL
REFER STANDARD NOTES

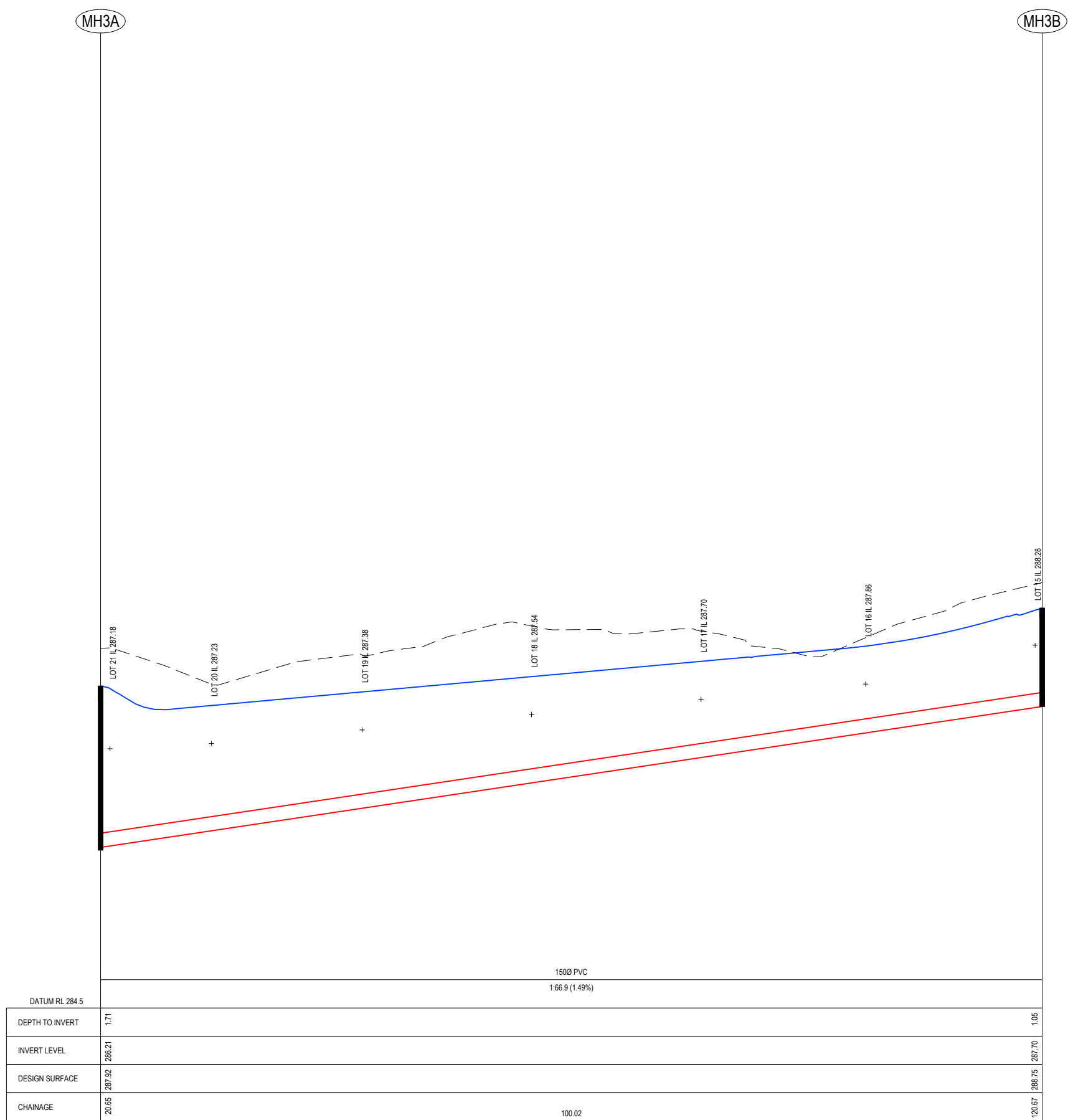

DATUM RL 284.5		1500 PVC		1.66.9 (1.49%)	
DEPTH TO INVERT	1.71				1.05
INVERT LEVEL	286.21				287.70
DESIGN SURFACE	287.92				288.75
CHAINAGE	20.65	100.02			120.67

CONCEPT PLAN

© COPYRIGHT. THE INFORMATION CONTAINED ON THIS DRAWING IS THE INTELLECTUAL PROPERTY OF TOMKINSON GROUP. COPYING OR USING THIS DRAWING IN WHOLE OR IN PART WITHOUT THE EXPRESS WRITTEN PERMISSION OF TOMKINSON GROUP INFRINGES COPYRIGHT

REV	REVISION	DES	DWG	CHK	DATE
B	AS SUBMITTED TO COLIBAN WATER - FULL SITE	NJB	NJB	RK	14/12/15
A	AS SUBMITTED TO COLIBAN WATER - STAGE 1 OUTFALL ONLY	NJB	NJB		07/10/15

Tomkinson Group
 PROJECT MANAGERS DEVELOPMENT PLANNERS ISO 9001:2008
 LICENSED SURVEYORS CIVIL ENGINEERS FS520488
 FREECALL: 1800 810 170 TEL: (03) 5445 8700 FAX: (03) 5441 3648
 PO BOX 421, BENDIGO 3552 57 MYERS STREET, BENDIGO 3550
 WEB: www.tomkinson.com EMAIL: bendigo@tomkinson.com

Principal CREJS PTY LTD

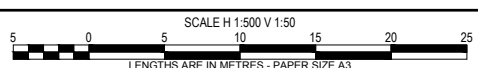

"THE RISE" STAGES 1 & 2
 LEE STRET & ARILPA COURT - KANGAROO FLAT
 SEWER LONG SECTIONS (SHEET 5 OF 5)

Water Authority & Ref:
 COLIBAN
 WATER
 ME - TBA

SHT 7 of 7 REV B

Drawing No.
 1070601S07

NOTE: THIS PLAN IS AN UNCONTROLLED DOCUMENT AND WILL NOT BE UPDATED. IT IS THE RESPONSIBILITY OF THE USER TO CONFIRM THAT THIS IS A CURRENT COPY AND SUITABLE FOR THE PROPOSED USE. THIS SHEET MUST BE READ IN CONJUNCTION WITH ALL SHEETS OF THIS SET AND ANY ACCOMPANYING DOCUMENTS. PLOT DATE: 14/12/2015 FILE: P:\JOB DATA\1070601\06-10795\10706 - CREJS PL - KANGAROO FLAT\10 ENGINEERING\CIVIL\CURRENT DESIGN\1070601 ENG PLANS.DWG